

Series 1 Bareshaft Pump Dimensions

Pump Model	Nominal Bore		Pump Dimensions				Foot Dimensions										Shaft Dimensions		
	Suction	Discharge	a	f	h1	h2	b	m1	m2	n1	n2	n3	s1	s2	v	w	y	d1	L
50x32-125	50	32	80	290	112	140	50	100	70	190	140	14	M12	M12	110	190	80	19	40
50x32-160	50	32	80	290	132	160	50	100	70	240	190	14	M12	M12	110	190	80	19	40
50x32-200	50	32	80	290	160	180	50	100	70	240	190	14	M12	M12	110	190	80	19	40
65x50-125	65	50	80	290	112	140	50	100	70	210	160	14	M12	M12	110	190	80	19	40
65x50-160	65	50	80	290	132	160	50	100	70	240	190	14	M12	M12	110	190	80	19	40
65x40-200	65	40	100	360	160	180	50	100	70	265	212	14	M12	M12	110	235	100	24	50
65x40-250	65	40	100	360	180	225	65	125	95	320	250	18	M12	M12	110	235	100	24	50
80x65-125	80	65	100	290	132	160	50	100	70	240	190	14	M12	M12	110	190	80	19	40
80x65-160	80	65	100	360	160	180	50	100	70	265	212	14	M12	M12	110	235	100	24	50
80x50-200	80	50	100	360	160	200	50	100	70	265	212	14	M12	M12	110	235	100	24	50
80x50-250	80	50	125	360	180	225	65	125	95	320	250	18	M12	M12	110	235	100	24	50
80x50-315	80	50	125	470	225	280	65	125	95	345	280	18	M12	M12	110	300	120	32	80
100x80-125	100	80	100	360	160	180	65	125	95	280	212	18	M12	M12	110	235	100	24	50
100x80-160	100	80	100	360	160	200	65	125	95	280	212	18	M12	M12	110	235	100	24	50
100x65-200	100	65	100	360	180	225	65	125	95	320	250	18	M12	M12	110	235	100	24	50
100x65-250	100	65	125	470	200	250	80	160	120	360	280	22	M16	M12	110	300	120	32	80
100x65-315	100	65	125	470	225	280	80	160	120	400	315	22	M16	M12	110	300	120	32	80
125x80-200	125	80	125	470	180	250	65	125	95	345	280	18	M12	M12	110	300	120	32	80
125x80-250	125	80	125	470	225	280	80	160	120	400	315	22	M16	M12	110	300	120	32	80
125x80-315	125	80	125	470	250	315	80	160	120	400	315	22	M16	M12	110	300	120	32	80
125x80-400	125	80	125	470	280	355	80	160	120	435	355	22	M16	M12	110	300	120	32	80
125x100-200	125	100	125	470	200	280	80	160	120	360	280	22	M16	M12	110	300	120	32	80
125x100-250	125	100	140	470	225	280	80	160	120	400	315	22	M16	M12	110	300	120	32	80
125x100-315	125	100	140	470	250	315	80	160	120	400	315	22	M16	M12	110	300	120	32	80
125x100-400	125	100	140	550	280	355	100	200	150	500	400	28	M20	M12	180	340	140	42	110
150x125-200	150	125	140	470	225	280	80	160	120	400	315	22	M16	M12	110	300	120	32	80
150x125-250	150	125	140	470	250	355	80	160	120	400	315	22	M16	M12	110	300	120	32	80
150x125-315	150	125	140	550	280	355	100	200	150	500	400	28	M20	M12	180	340	140	42	110
150x125-400	150	125	140	550	315	400	100	200	150	500	400	28	M20	M12	180	340	140	42	110
200x150-200	200	150	160	530	250	355	80	160	120	400	315	22	M20	M12	110	370	120	42	110
200x150-250	200	150	160	550	280	375	100	200	150	500	400	28	M20	M12	180	340	140	42	110
200x150-315	200	150	160	550	315	400	100	200	150	550	450	28	M20	M12	180	340	140	42	110
200x150-400	200	150	160	550	315	450	100	200	150	550	450	28	M20	M12	180	340	140	42	110
200x150-500	200	150	160	630	400	500	120	250	180	620	550	35	M20	M12	180	400	180	55	110
200x200-250	200	200	180	550	280	400	100	200	150	550	450	28	M20	M12	180	340	140	42	110
200x200-315	200	200	180	550	315	450	100	200	150	550	450	28	M20	M12	180	340	140	42	110
200x200-400	200	200	180	630	355	450	120	250	180	620	550	35	M20	M12	180	400	180	55	110
250x250-400	250	250	200	630	400	515	120	250	180	670	550	35	M20	M12	140	400	180	55	110

Not for manufacture. Certified drawings are available on request
All Dimensions are in mm & subject to change without notice



28 MOONEY STREET, BAYSWATER WA 6053
PO BOX 170, BAYSWATER WA 6933
TELEPHONE 61 8 9271 7599
FACSIMILE 61 8 9271 0926
EMAIL pumpeng@bigpond.com

SERIES 1

THERE IS AN ALTERNATIVE



The PumpEng "Series 1" pump is manufactured as an alternative to and competes directly with the Ajax IS range of centrifugal pumps.

The PumpEng "Series 1" pump offers interchangeable spare parts, hydraulic performance and overall dimensions to the Ajax IS.

Available in:-

- Ni-Resist- "Corrosion and wear resistant Iron"
- Various grades of Bronze
- Ductile iron
- Various grades of Stainless Steel
- Specialty alloy materials

SERIES 1 RANGE SELECTION CHART

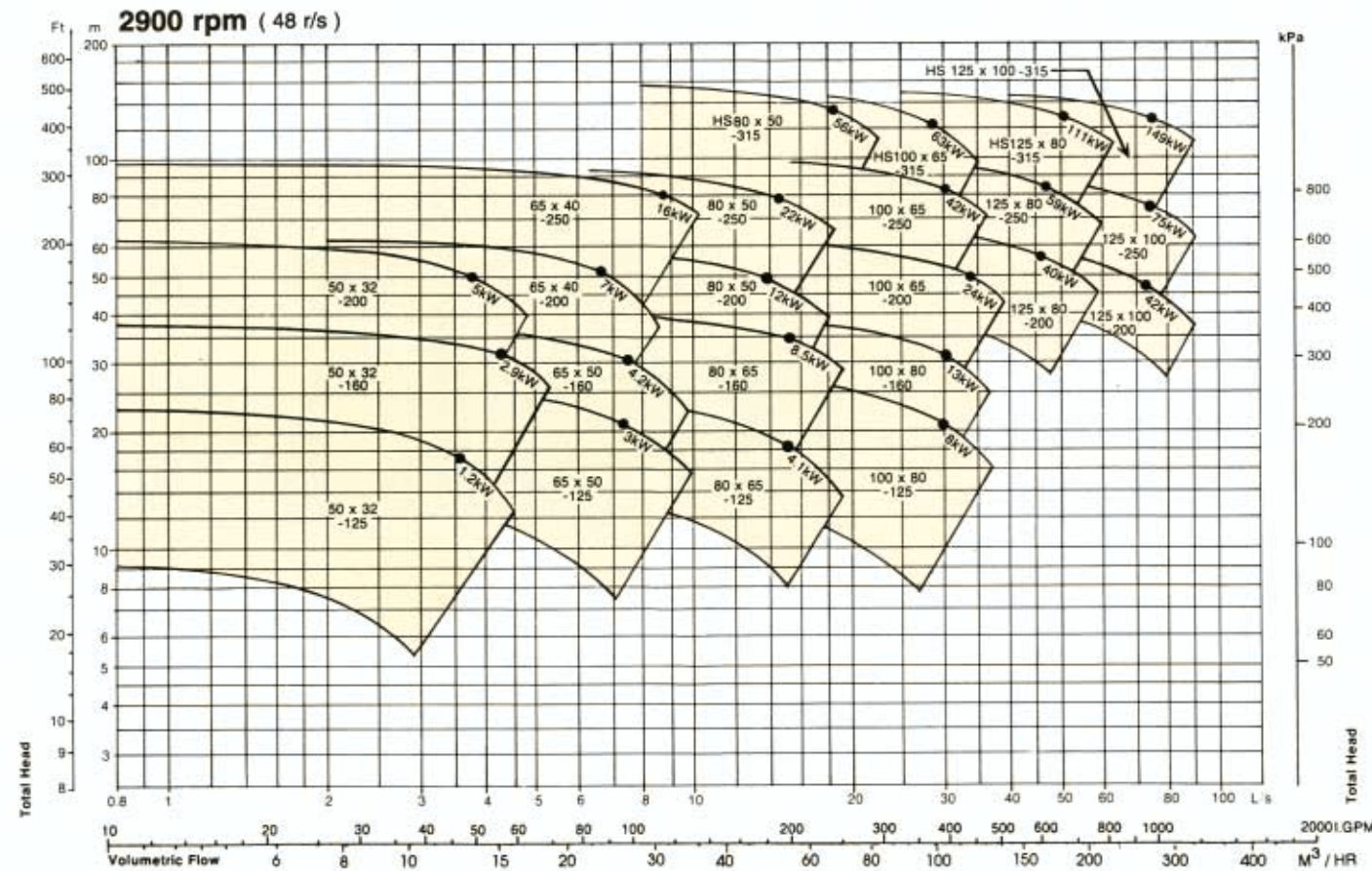
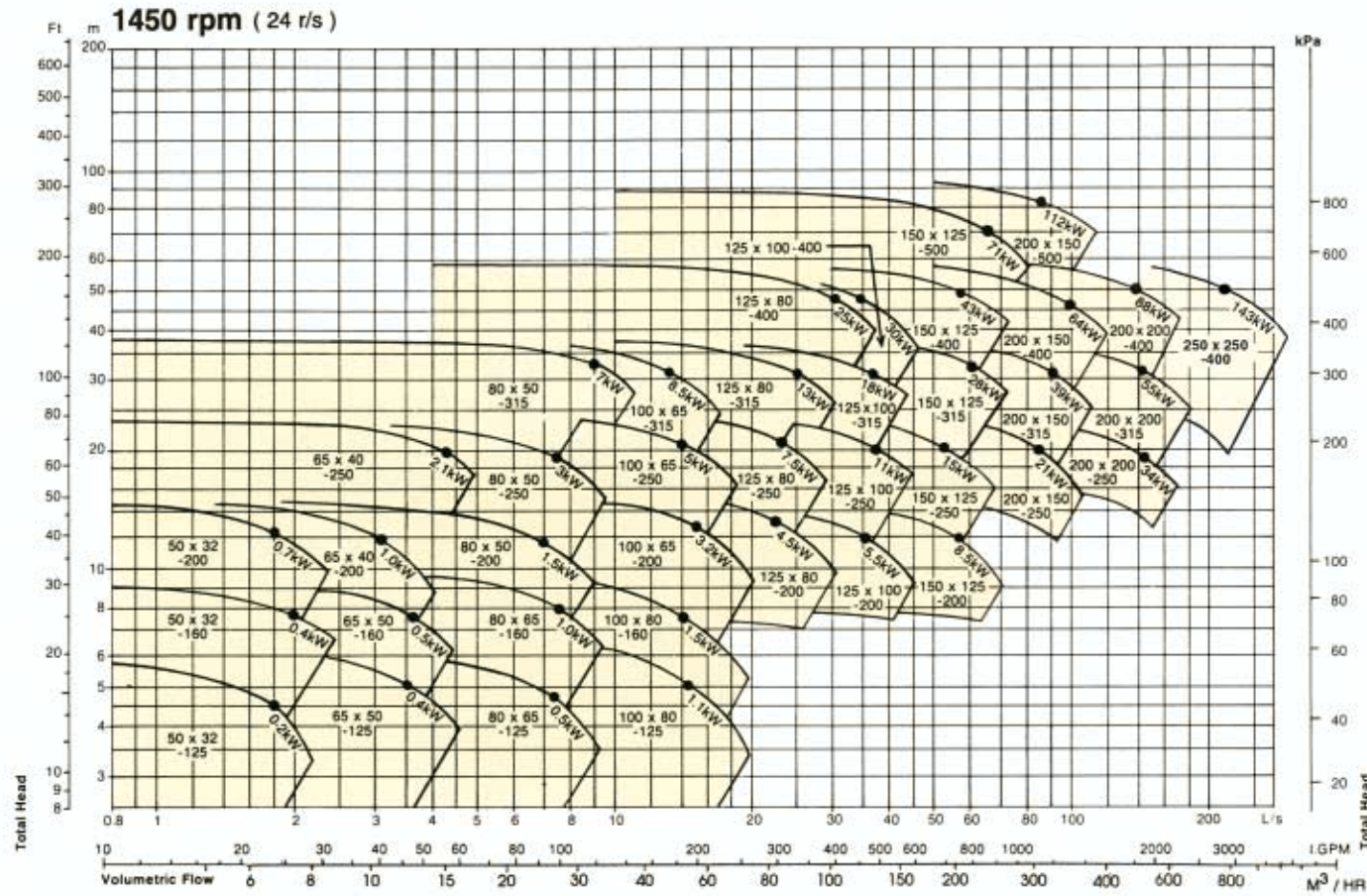

Conversions

Head: 10ft. = 3.048 m; Flow: 100 i gal/min = 7.577 L/s; 100 US gal/min = 6.309 L/s; Power: 10 hp = 7.457 kW

Point of maximum efficiency. Non overloading power

FOR FINAL SELECTION REFER TO INDIVIDUAL PUMP CURVE

PRODUCT FEATURES

CASING	Foot mounted, end suction, single stage & vertically split back pull-out pump offering increased maintenance efficiency. Generally complying with ISO 2858 specification. Pressure testing is conducted on all casings.
FLANGES	Flanges according to ISO 7005, rated to 16 bar pressure and drilled in accordance with "TABLE E" as per AS2129-1978. Alternative flange drilling is available upon request.
IMPELLER	Closed vane impellers, produced in one piece with front and rear sealing areas and incorporating hydraulic balancing holes. All impellers are statically balanced.
SHAFT	CNC machined stainless steel shaft is designed to take the full load stress with minimum deflection.
SHAFT SEAL	High quality Carbon/Ceramic/Nitrile mechanical seal fitted as standard. Optional mechanical seal materials and Packed Gland shaft seals are available.
BEARINGS	Fitted with deep groove sealed for life ball bearings as standard. Periodic greasing is not required.
PUMP DESIGN	This pump generally encompasses the standards of ISO 2858, ISO 7005 and ISO 3069. High precision machining to strict quality control ensures that tolerances and clearances are maintained. Working pressures to 16 bar and temperatures to 100° Celsius are accommodated.

PARTS LIST

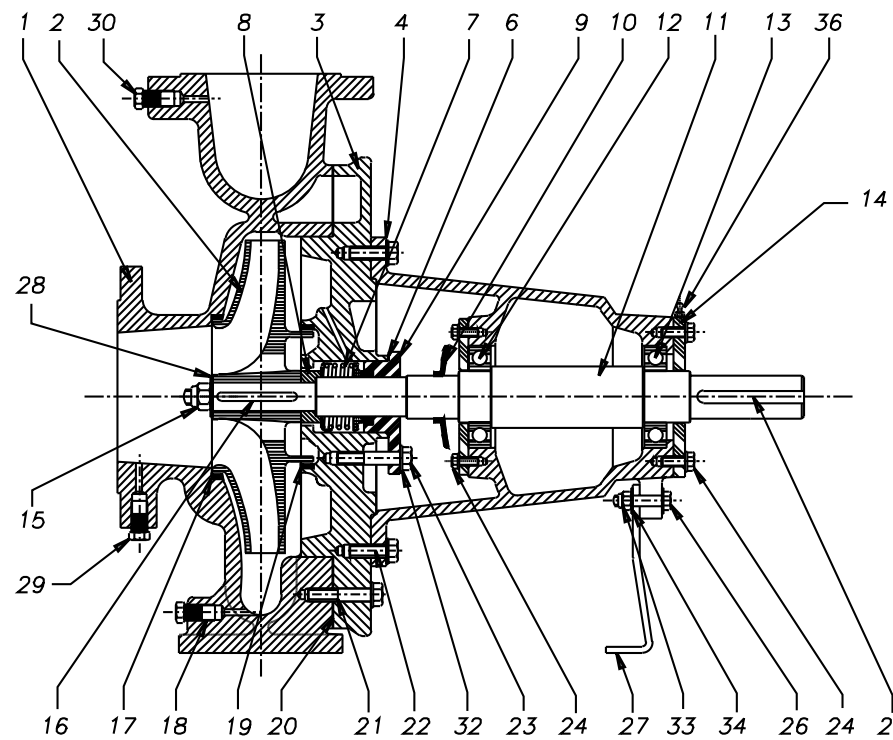

ITEM No.	DESCRIPTION
1	VOLUTE CASING
2	IMPELLER
3	BACKPLATE
4	BEARING PEDESTAL
6	SEAL PLATE GASKET
7	MECHANICAL SEAL
8	MECHANICAL SEAL COLLAR
9	MECHANICAL SEAL PLATE
10	WATER SLINGER
11	SHAFT
12	BEARING N.D.E.
13	BEARING D.E.
14	BEARING COVER
15	IMPELLER NUT
16	IMPELLER KEY
17	FRONT CASING WEAR RING
18	DRAIN PLUG
19	REAR CASING WEAR RING
20	CASING GASKET
21	CASING BOLT/STUD
22	BACK COVER BOLT
23	SEAL PLATE STUD
24	BEARING COVER BOLT
25	COUPLING KEY
26	SUPPORT FOOT BOLT
27	SUPPORT FOOT
28	IMPELLER WASHER
29	SUCTION FLANGE PLUG
30	DISCHARGE FLANGE PLUG
32	SEAL PLATE WASHER
33	SUPPORT FOOT NUT
34	SUPPORT FOOT WASHER
36	GREASE NIPPLE